

▶ Application

HY series two direction switch is applicable for circuit of AC50Hz, rated voltage 380V and above, rated operational current up to 20A, as directly connecting and breaking one Squirrel cage induction motors, for motor reversing, forwarding and stopping.

This production conforms to Standard of GB14048.3, IEC60497.3.



▶ Model No.

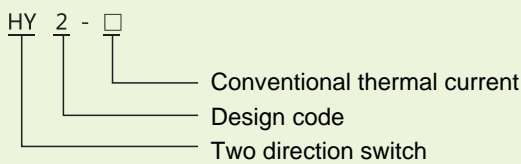

▶ Normal working condition and installation condition

3.1 Altitude: lower than 2000m.

3.2 Ambient temperature: no higher than +40°C, and no lower than -5°C, and day average temperature shall no more than +35°C.

3.3 Humidity: Relative humidity shall not exceed 50% at the Max temperature 40°C, and higher humidity could be accepted at lower temperature. The condensation must be taken care which is caused by temperature change.

3.4 Pollution class: III type

3.5 Installation level: II, III type

Using type: AC-3, AC-4

▶ Main Technical data

4.1 see Table1

Table1

Model No.	conventional thermal current(A)	Rated operational current(A)	Rated operational power(kW)	
			Ue380V	Ue220V
HY2-15	15	8	3	1.8
HY2-30	30	12	5.5	3
HY2-60	60	20	10	5.5

► Notice

- 1 This series production can not used as one item power control, and it also can not install at moist or corrosion gas environment.
- 2 This production can be used as stopping the motor at rated capacity.
- 3 This production shall be taken regular inspection of contact surface and rotation mechanism. If there is a single and unflexible phenomenon, Please cut off the power to take repair.

► Appearance and mounting dimensions

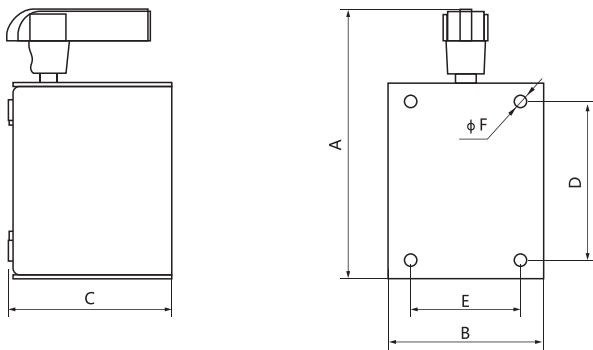
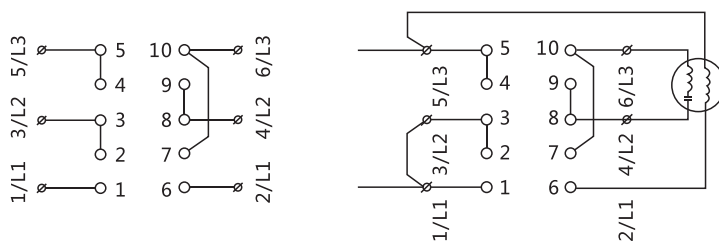

Table2

Model No.	A	B	C	D	E	F
HY2-15	132	79	82	70±0.3	60±0.3	φ 5
HY2-30(60)	147	86	98	80±0.3	65±0.3	φ 5

► Connection diagram



Control Three phases motor connection diagram Control Single phases motor connection diagram

Table3

Rotation direction	connection point		
clockwise	1-6	3-8	5-10
anticlockwise	4-9	2-7	5-10